



## 61 Jersey Road, Strood, Rochester, Kent, ME2 3PB

GUIDE PRICE £350,000 TO £360,000. LARGE GARDEN. DRIVE TO FRONT. DESIRABLE LOCATION. WALKING DISTANCE TO TOWN AND STATION.

MMS are presenting a fantastic opportunity to purchase this 4 bedroom 1930's end of terrace house with bay windows, a classic feature for this age property. Being tastefully extended on the ground floor and offering good size living space. Accommodation comprises of entrance hall, internal study room/utility room, a spacious lounge with a feature bay window to the front and an open fire, dining area and fully fitted kitchen. The good size family bathroom is also located on the ground floor. From the kitchen you have access via French doors to a good size garden, that is perfect for entertaining family members and guests. Offering a patio area, lawn area and a summer-house to the rear with side access to the front. On the first floor is the landing and the 4 bedrooms, with feature painted floor-boards. There is a drive for 1 car to the front. Jersey Road is a highly popular residential area and is within walking distance to several primary schools, the town centre and train station. Call us today to book your viewing.

- 4 BEDROOMS
- STUDY/UTILITY ROOM
- DRIVE TO FRONT
- SUMMER-HOUSE
- GUIDE PRICE £350K-£360K
- TASTEFULLY EXTENDED
- HIGHLY POPULAR LOCATION
- PERFECT FAMILY HOME
- MODERN FITTED KITCHEN
- GOOD SIZE REAR GARDEN

**£350,000**

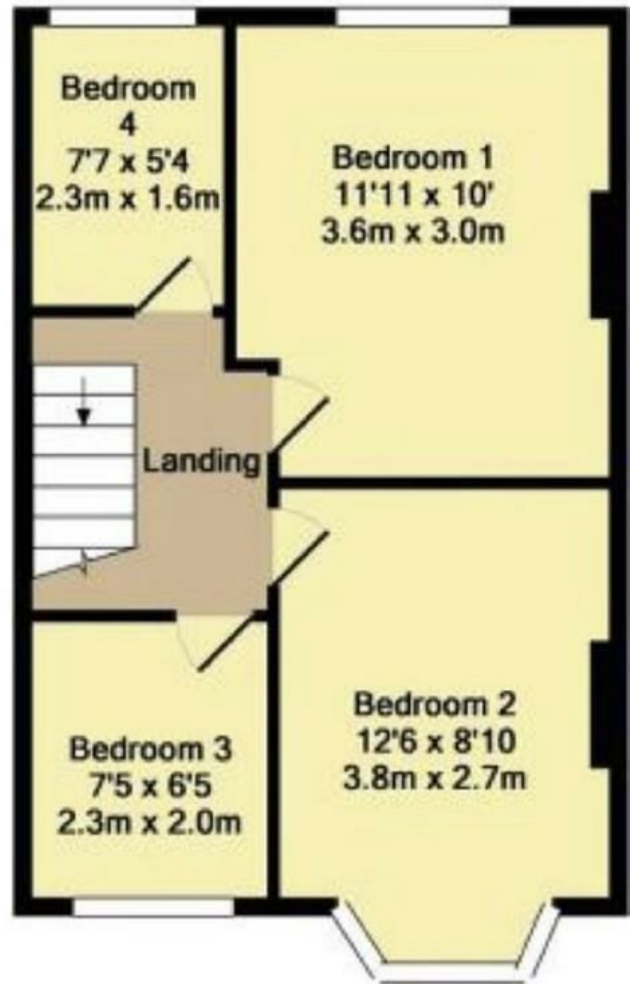

Energy Efficiency Rating		Current	Potential
Very energy efficient - lower running costs			
(92 plus) <b>A</b>			
(81-91) <b>B</b>			
(69-80) <b>C</b>			
(55-68) <b>D</b>			
(39-54) <b>E</b>			
(21-38) <b>F</b>			
(1-20) <b>G</b>			
Not energy efficient - higher running costs			
		54	74
<b>England &amp; Wales</b>		EU Directive 2002/91/EC	

Environmental Impact (CO <sub>2</sub> ) Rating		Current	Potential
Very environmentally friendly - lower CO <sub>2</sub> emissions			
(92 plus) <b>A</b>			
(81-91) <b>B</b>			
(69-80) <b>C</b>			
(55-68) <b>D</b>			
(39-54) <b>E</b>			
(21-38) <b>F</b>			
(1-20) <b>G</b>			
Not environmentally friendly - higher CO <sub>2</sub> emissions			
		1	1
<b>England &amp; Wales</b>		EU Directive 2002/91/EC	